

Our Own Gaskets

Quality is our passion!



Your gasket professionals

Made in Germany



Manufacturing Program (selection)

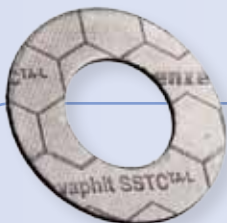

Graphite gaskets



Fibre-optic gaskets - compounded with elastomers



Asbestos-free sealing material (Aramid fibre)

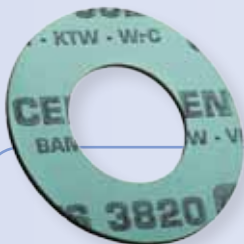

Fibre gaskets (KTW-approval of German Federal Environment Agency)

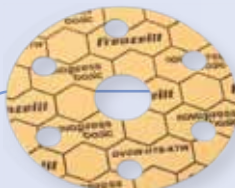

Fibre gaskets, Aramid and NBR-rubber



Elastomers with guaranteed properties, also in rolls and sheet format



Asbestos-free sealing material

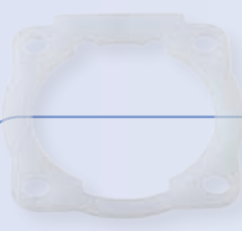

Silicon gaskets

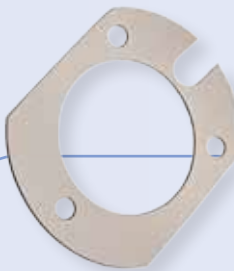

NBR light, FDA-compliant



Wear resistant rubber gaskets



Rubber-steel gaskets

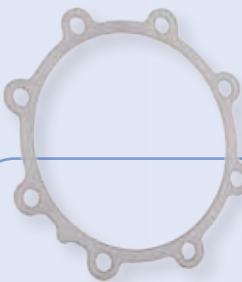

Gaskets from industrial plastics



Gaskets with inner eyelet and outer eyelet



Sieve gaskets

Materialien

All gasket materials used are either top brand materials or as specified by the customers. Whether you need graphite, fibres, elastomers, technical plastics etc., we stock about 2,200 different materials for you.

Company History

From sole proprietor to medium sized business

Our company history started as a sole proprietorship in 1994. Our first premises were in a rented attic office at the Loederburg/ Germany commercial district "Schacht VI". Major business was the manufacturing of industrial gaskets, the distribution of sealing technology and technical trade. We started with two staff members only.

In 1999 Mr. Ralf Moeller, our owner, invested in a new site at the commercial district of Hecklingen. Soon, two more buildings were added.

In 2004 the premises were extended and the go-ahead for the erection of a large warehouse was given. Soon the capacity was reached. Therefore, another large warehouse was built in 2011. Today, we store 2,200 different materials in 9,000 storage spaces located on 6,500 m² in order to ensure speedy gasket manufacture and prompt delivery.

Strategicly planned investments in state-of-the-art machinery and equipment ensure premium gaskets, flexibility and reliability for Technical Dealers.



Moeller started behind these two attic windows.

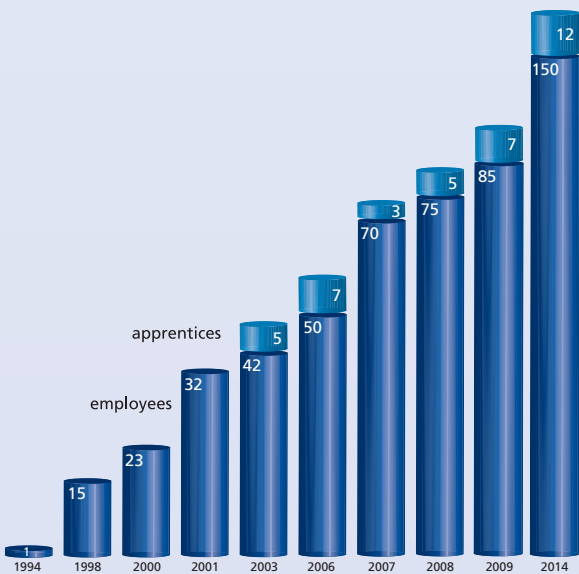

1 March 1994 - company foundation

1994 - first rented warehouse

1996 - moving to a larger site

1999 - New building 1: start of manufacturing at Hecklingen

2001 - new building 2: shipping, CNC-plotter

2003 - new building 3: water jet cutting area

2004 - new building 4: receiving area, warehouse

2009 - new building 5: Moeller Metal Gaskets

2011 - new building 6: large warehouse



Everything where it should be

Warehouse Inventory



6,500 square metres
9,000 storage spaces

We stock more than 2,200 materials. Among them there is the wide range of gasket materials, rolls and sheets, elastomers as well as high-tech sealing materials.

This comprehensive inventory ensures fast order processing and thus short delivery times.

Manual production for special designs

Even though the age of computerized production has reached all areas of industry for a long time, manual production is sometimes needed for specific orders. Our skilful and experienced staff at the manual production department is specialized in the manufacturing of odd sizes and formats.



First, preliminary cutting takes place at our CNC-knife cutting tables or by means of water jet cutting. At the segment and part production we use good manufacturing practice to guarantee high quality products.

Flexible Production

Stamping Division

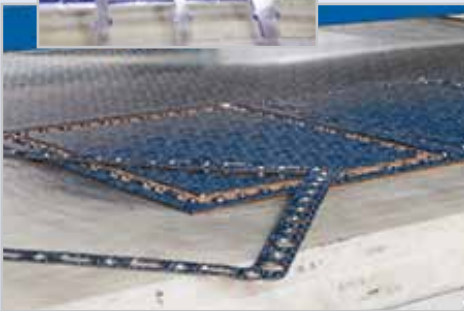

Whether individual gaskets, small lots or mass production, we use optimal gasket punches for each type of manufacturing. Therefore we ensure maximal utilization of material. Our machinery includes eccentric presses, travelling-head cutting machines, beam cutting presses, gang punches as well as automatic punches for bulk orders.

Years of experience with mechanical and thermal properties of raw materials guarantee handling according to good professional practice during the punching process. This results in gaskets dimensionally accurate.

Whether we make a model gasket or process bulk orders, short lead times are guaranteed.



Almost any material

Utilizing the power of water



Our three water jet cutting machines can cut any material. Whether large shapes or delicate gaskets with narrow radii - water jets can virtually cut everything.

Softer materials such as rubber are cut with clean water. For hard materials such as stainless steel, quartz sand is added to the jet. Besides gaskets we also manufacture other applications to customers' specifications on our water jet cutting machines.



Process Optimization

The clear cut - CNC plotter



Computer-aided production also enables digital filing of drawings. Our digital database of drawings can be accessed at any time. Therefore, follow-up orders can easily be processed with limited paperwork involved. This constitutes cost and time advantages for our customers.

Modern and fast CNC plotters cut out any shape of gasket, making full use of the material. Whether tightest radii or long straight cuts, high precision is standard.

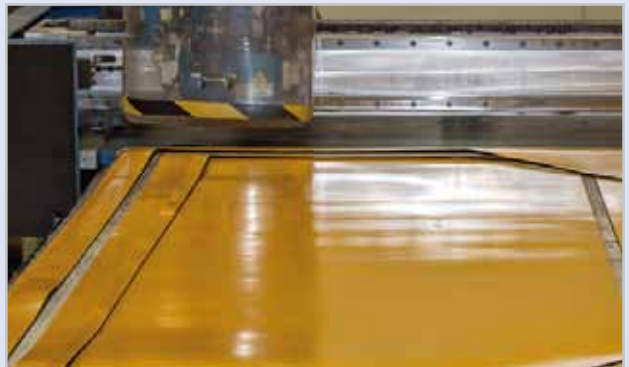

Own Tool-Making

Precision makes quality



Strip steel cutting tool-making

High quality stamping tools are necessary to start manufacturing shortly after receiving orders. We make the necessary stamping tools according to specifications in either our own strip steel cutting tool-making unit. Toolmakers build the tools directly needed for gasket production according to drawing or sample. All tools are registered and stored for reuse. The tools are immediately available for follow-up orders.



Mechanical tool-making

High performance stamping tools for punching machines as well as tools with small radii or odd shapes are produced in our own mechanical tool-making department (bottom). Modern machinery ensures not only high precision of the tools, but also a job-related rapid tool manufacture. The mechanical tool-making department has also specialized in the production of injection molds and the development of machines and plants for the production of gaskets.



Gaskets with Eyelets

Gaskets with support structures

Graphite or fibers can withstand higher loads when supported. We make gaskets with inner eyelets as well as outer eyelets. Eyelet materials are mainly stainless steel or copper. Depending on customer requirements, the eyelets are produced in welded or continuous design.

By using a modern laser welding process we create a perfect connection without material discoloration. Thus, the properties of the eyelet materials can be kept.



Quality is our Passion

Tested gasket quality

The quality of all gaskets begins with the inspection of incoming goods. In-process inspections during manufacturing ensure a consistent quality. Only goods that have successfully passed our final inspection go into dispatch.

Materials and gaskets are continually tested in our own laboratory. Gasket compounds are mainly determined by the properties of the respective gasket. These properties can be characterized in terms of characteristic parameters. Based on these characteristic parameters the use of one gasket can be optimally determined. In addition, characteristic parameters are a clear proof of quality assurance. In the laboratory, long-term properties, sealing properties and deformation properties are determined.

The tightness and compliance with a maximum leakage rate of a gasket compound is determined by the predeformation of the gasket. During our test, we determine the elastic recovery and the real elastic-plastic behavior of the gasket. The comprehensive test results are available at any time.



Shipping Service

Well packaged for customers



Immediately after the completion our gaskets come to the dispatch area. Our experienced staff know how to handle materials in order to ensure undamaged and safe delivery.

It is always our customer's decision whether to deliver to their address or, in order to save time, directly (and using neutral packaging) to their customers.



Container-Service

Our container service ensures a smooth on-site supply of engineers with all necessary gaskets and sealing materials during plant shutdown.

Our customers do not need to stock large quantities of gaskets which might be needed.

This container service is very complex and therefore, needs to be discussed in advance.



Designs and calculations



The very experienced Moeller Metall-Dichtungen Department of Application Engineering supports you in interpreting and calculating of flanged connections. We attempt a holistic approach to the point to be sealed.

Our services include mathematical proof of flange connections on equipment and piping according to AD 2000 instruction B7/B8, ASME VIII Div.I app. 2, EN 1591-1 and EN 13445-3 in all standard calculation programs (e.g. TÜV Dimy, PV Elite, Compress) or using the finite element method (FEM, e.g. ANSYS) with reasonable utilization of the bolt materials (preferably 70% Rp 0.2) and determining the required torque for the bolts.



Quality Management

As a medium-sized enterprise, we see it as one of our most important goals to fulfill the expectations of our customers quickly, flexibly and with high quality. Therefore, our task is to meet customers' demands in a way beneficial for both sides.

At the same time we are committed to our corporate social responsibility in the fields of occupational safety, health and environmental protection. We want to fully protect our employees from hazards and impairments in the work process and ensure the safety of third parties involved, neighbouring companies as well as local residents. Furthermore, it is our declared goal to prevent damage to property and the environment. To achieve this goal, we commit ourselves to the implementation of a comprehensive work safety management system, which enables a systematic risk analysis and assessment as well as risk mitigation and risk prevention by means of appropriate measures.

The implementation of the integrated management system ensures that all quality and safety-related activities are planned, controlled and monitored to ensure full compliance with

DIN EN ISO 9001 : 2008

OHSAS 18001 : 2007.

Compliance with customers' requirements as well as contractual agreements is taken care of.



Moeller gaskets - you can rely on !



- Advanced manufacturing technologies
- Each gasket tested and certified
- 24 hours regular throughput time for all orders
- Fast installation with precision fit
- All gaskets Made in Germany - Guaranteed!
- Technical consulting and training
- Experience
- Designs and calculations
- Collaborative partners